

Operating Instructions

EN KNIPEX Tethered Tools Tool bags

00 50 50 T LE
00 50 51 T LE



CONTENTS

1	General information	3
1.1	Notes on operating instructions	3
1.2	Symbols used	3
1.3	Copyright	3
1.4	Guarantee and warranty	3
2	Safety	4
2.1	Intended use	4
2.2	Safety Instructions for operation	4
2.3	Certified safety	5
3	Structure and function	6
3.1	Design of the Tool Bag	6
3.2	Function	7
3.3	Product Overview and Technical Data	7
3.3.1	Dimensions	7
4	Equipment of the Tool Bag	8
4.1	Transport of tools in the Tool Bag	8
4.2	Transport of bottles, spray cans or other objects in the side pockets	8
4.3	Transport of documents or tablet/PC in the front pocket	9
4.4	Labeling the Tool Bag	9
5	How to use the Tool Bag	10
5.1	Transport of the Tool Bag	10
5.2	Connecting the Tool Bag to primary anchoring locations (body, lifting device, or structure)	10
5.3	Fastening tools in the Tool Bag	11
5.3.1	To use the carabiner end	11
5.3.2	To use the loop end	11
5.3.3	Connecting Adapter Straps	12
5.4	Opening the top cover	13
5.5	Use of tools	13
6	Inspection	14
7	Storage and Care	14
8	Disclaimer	14

1 General information

1.1 Notes on operating instructions

These operating instructions are for use with KNIPEX Tethered Tools Tool Bag. The illustrations and descriptions contained in these operating instructions may differ slightly from the Tool Bag actually delivered.

KNIPEX-Werk C. Gustav Putsch KG is not liable for damage caused by failure to observe these operating instructions.

1.2 Symbols used

All safety instructions in this operating instructions are indicated by corresponding symbols. The signal words at the beginning of each safety instruction express the extent of the hazard.



Risk of serious to fatal injuries

This combination of symbol and signal word indicates an imminently hazardous situation that will result in death or serious injury if not avoided.



Warning of potentially serious fatal injuries

This combination of symbol and signal word indicates a possibly hazardous situation that may result in death or serious injury if not avoided.



Caution

Indicates a hazardous situation that, if not avoided, could result in minor or moderate injury.

1.3 Copyright

These operating instructions and all documents supplied with the KNIPEX Tethered Tools Tool Bag are protected by copyright and remain the property of KNIPEX.

The reprinting of these instructions, even in part, is only permitted with the written consent of KNIPEX Werk C. Gustav Putsch KG.

1.4 Guarantee and warranty

The manufacturer grants a statutory warranty in accordance with the current sales and delivery conditions. No further warranties or assurances are granted.

Within the warranty period, the warranty covers the rectification of all defects that can be traced back to material faults or manufacturing errors.

Wearing parts are excluded from the warranty.

Warranty is voided if any of the conditions exist:

- Damage is caused through improper operation, use for purposes other than those specified by the manufacturer, or poor maintenance.

2 Safety

2.1 Intended use

The products are intended for the following uses:

- All elements of the KNIPEX Tethered Tools System are designed to be used for tool tethering only. The weight of the tool must not exceed the permitted capacity for any tethering system component.
- Only connect KNIPEX Tethered Tools Lanyards or Adapter Straps to tools with captive tethering points that are engineered as tether points.

Any use beyond the intended purpose or any unauthorized modification shall be considered improper. The operator shall be liable for damages resulting from improper use.

Intended use also includes adhering to these operating instructions. They must be read and understood in full before use.

The users must be trained regarding to tool securing and the safe use of tools at heights. In order to reduce the hazards of **working at heights with tools**, the following instructions must be followed to avoid the risk of serious injury or death.

2.2 Safety Instructions for operation

⚠ DANGER

Risk of falling from slipping, stumbling, twisting and from people falling onto a lower surface or an object!

KNIPEX Tethered Tools Tool Bags are for tool transport only. They are not for human or animal support, nor are they intended to be part of a human fall protection system.

⚠ DANGER

Risk of injury from moving parts!

Do not use around machinery with exposed turning or moving parts.

⚠ DANGER

Risk of falling due to falling heavy tools!

Heavy, falling tools can make you loose your balance and falls can occur.

If possible, use a separate fixed anchor point for equipment with weights over 2.26 kg (5 lbs).

⚠ WARNING

Risk of injury from falling objects!

Observe the following safety instructions when using KNIPEX Tethered Tools Tool Bag.

- Never exceed the permitted capacity for any tethering system component.
- Each KNIPEX Tethered Tools Tool Bag **MUST** be inspected prior to each use in accordance with the Instruction Manual.
- If a KNIPEX Tethered Tools Tool Bag has been subject to fall arrest forces, it must be immediately inspected for damage by a competent person prior to continued use. If any doubt, it must be removed from service.

- Do not make modifications to the KNIPEX Tethered Tools Tool Bag
- Never make attachments to tools or equipment in a manner that would allow the KNIPEX Tethered Tools Tool Bag to be unintentionally disconnected.
- Ensure the KNIPEX Tethered Tools Tool Bag is kept free from any and all obstructions including, but not limited to, entanglement with other workers, yourself, and surrounding objects.
- Do not use a KNIPEX Tethered Tools Tool Bag if it will interfere with the safe working condition, or operation of the tool or equipment it is attached to.
- Only connect KNIPEX Tethered Tools Tool Bag to Anchor Points that are suitable and reliable for tool tethering.
- Only connect KNIPEX Tethered Tools Tool Bag to tools with captive tethering points that are engineered as tether points.
- Ensure there is adequate clearance in the event of a tool drop. Tool fall/swing path must not endanger yourself, other personnel, or any surrounding equipment or materials.
- Do not use the KNIPEX Tethered Tools Tool Bag in temperatures below -35 °C / -30 °F or above 45 °C / 113 °F.

CAUTION

General notes

- All procedures shown in these instructions are for KNIPEX Tethered Tools Tool Bags only.
- All incidents of dropped tools should be reported to your supervisor or safety coordinator. Involved KNIPEX Tethered Tools Tool Bags must be inspected for damage immediately (see chapter "Inspection").

2.3 Certified safety



The products are tested and conform according to **ANSI ISEA 121-2018**.

The usability and loading capacity of the Tool Bags have been independently tested and certified.

(VPA TESTED by VPA Prüf- und Zertifizierungs GmbH, 42859 Remscheid Germany)

STRUCTURE AND FUNCTION

3 Structure and function

3.1 Design of the Tool Bag



Figure 1: Terms and definitions - Example 00 50 50 T LE, 10.0 kg (22 lbs)

- 1 Top Cover
- 2 Hook and loop fastener (like Velcro) for individual labeling with badges (100 x 200 mm)
- 3 Carrying strap (for transport on solid ground only)
- 4 Side pocket (left and right side) e.g. water bottles or spray cans
- 5 Tool holder (left and right side) for e.g. tape measure or cordless drills
- 6 2 elastic loops to keep the cover open
- 7 3 D-rings on the backside to attach the bag to climbing equipment or a fixed point
 - Part # 00 50 50 T LE: maximum static load 10.0 kg (22 lbs)
 - Part # 00 50 51 T LE: maximum static load 15.0 kg (33 lbs)
- 8 Reinforced bottom with 5 rubber feet
- 9 4 D-rings at the rear of the inside to attach the tools
- 10 Inside
 - 2 compartments for tools, 4 D-rings at the rear (position 9), 1 D-ring each at the left and right side, 18 elastic band tool loops
- 11 Pocket for documents or tablet/PC, holder for 2 pens
 - Max. document size:
 - 00 50 50 T LE: DIN A5 (148 x 210 mm / 5.8" x 8.3")
 - 00 50 51 T LE: DIN A4 (210 x 297 mm / 8.3" x 11.7")
- 12 Hook and loop straps to close the document pocket
- 13 1 D-ring on the left and right side for fastening the carrying strap for transporting the Tool Bag on solid ground
 - Part # 00 50 50 T LE: maximum static load 10.0 kg (22 lbs)
 - Part # 00 50 51 T LE: maximum static load 15.0 kg (33 lbs)OR for attaching KNIPEX tethered tools (maximum dynamic load 3.0 kg / 6.61 lbs)

Only tools weighing less than 3.0 kg / 6.61 lbs may be attached to the 8 D-rings (6 in the inner compartment and one each on the left and right outside of the bag).

STRUCTURE AND FUNCTION

3.2 Function

Tools that do not exceed the permitted capacity for any tethering system component and have a captive tethering point engineered into them can be tethered with the KNIPEX Tethered Tools Lanyards and Adapter Straps.

3.3 Product Overview and Technical Data



Product No.	Type	Height (H)	Width (W)	Depth (D)	Load rating	Weight
00 50 50 T LE	Tool bag	300 mm (12")	250 mm (10")	150 mm (6")	10.0 kg (22 lbs)	1.4 kg (3 lbs)
00 50 51 T LE	Tool bag	470 mm (18")	250 mm (10")	150 mm (6")	15.0 kg (33 lbs)	1.6 kg (3.5 lbs)

3.3.1 Dimensions



Figure 2: Dimension drawing

H: Height of the Tool Bag with cover open (see table)

B: When the outer pockets are full they expand up to 60 mm / 2.36" wider

4 Equipment of the Tool Bag



Figure 3: Attachment of tools and other objects with Lanyards or Adapter Straps (TOOLS NOT INCLUDED!)

4.1 Transport of tools in the Tool Bag

Tools can be transported in the two inner compartments. The total weight of the bag must not exceed 10 kg / 22 lbs (00 50 50 T) or 15 kg / 33 lbs (00 50 51 T).

Each tool and object in the Tool Bag must be attached to one of the D-rings with a Lanyard or Adapter Strap.

Tools can be inserted into the elastic band tool loops on the inside of the bag to facilitate access to the individual tools and to fix them in the bag.

4.2 Transport of bottles, spray cans or other objects in the side pockets

Bottles, spray cans (e.g. grease or marking sprays) or other objects can be transported in the side pockets of the Tool Bag.

These items must also be attached to one of the D-rings via a lanyard using suitable fastening material for cans and bottles (see figure 3).

4.3 Transport of documents or tablet/PC in the front pocket



Figure 4: Closing the document pocket

Documents and tablet/PC can be stored in the front pocket for easy transportation.

The front pocket must be closed with the two flaps with hook and loop fastener. Documents or a tablet/PC must be additionally fastened to a D-ring with a Lanyard using suitable fastening material.

4.4 Labeling the Tool Bag



Figure 5: Labeling the Tool Bag

The hook and loop fastener on top of the bag can be used for individual labeling of the Tool Bag with badges. Labels with hook and loop fasteners can be attached here, e.g. to mark the contents of the bag.

Tools must not be attached to the hook and loop fastener!

5 How to use the Tool Bag

5.1 Transport of the Tool Bag

For transporting the Tool Bag on the ground, a carrying strap can be hooked onto the two D-rings on the side.

⚠ WARNING

Risk of injury from falling objects!

The carrying strap is only suitable for transport on solid ground.

The carrying strap **must not** be used to pull the bag up onto a scaffold. The carrying strap **must not** be used to attach the bag to climbing equipment or structures at height.

Attach a suitable lifting device to the D-rings on the outside of the bag if you want to pull the bag up.

5.2 Connecting the Tool Bag to primary anchoring locations (body, lifting device, or structure)

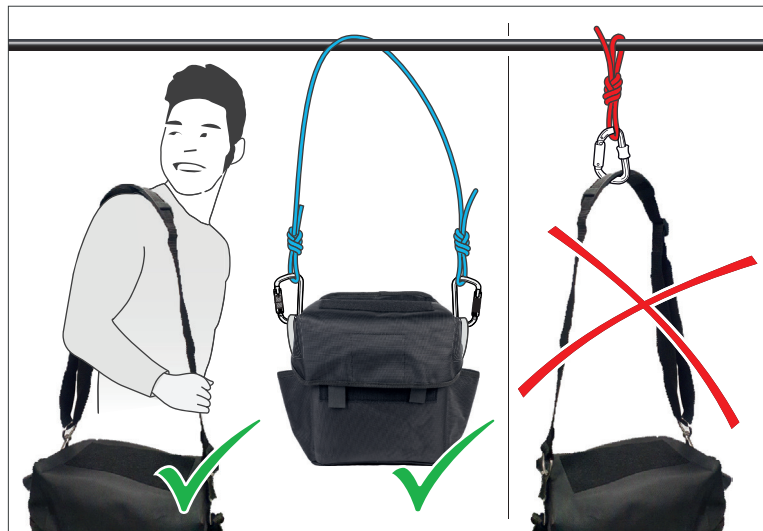

Figure 6: Tool Bag anchored to a structure

1. During ascent and descent, tools and bag can be attached to the climbing equipment. Make sure that it is as close to the body as possible and cannot get caught. If it is possible to pull up the tools and bag separately, this option is preferable.
2. Tools weighing more than 2.26 kg (5 lbs) must, whenever possible, be anchored to a structural anchorage or lifting device.
3. For best practice anchor your Lanyard to a structure other than the users body. If the user does anchor the Lanyard to their body, select an anchor location in the middle of your body. Be sure to have a secure stance, because falling tools can make you lose your balance.
4. For any questions or concerns about selecting appropriate anchor points, consult a qualified person.

Attach the other end of the Lanyard to an anchor point that is suitable and reliable for tool tethering either by loop or by a carabiner.

HOW TO USE THE TOOL BAG

5.3 Fastening tools in the Tool Bag

Each tool must be attached to one of the D-rings inside the Tool Bag with a Lanyard or Adapter Strap.

Several tools can be attached to one D-ring as long as the total weight of the D-ring does not exceed 3 kg /6.6 lbs.

Attach an end of the Lanyard or Adapter Strap to a tool. Either the loop end of the Lanyard or the carabiner end may be used.

5.3.1 To use the carabiner end

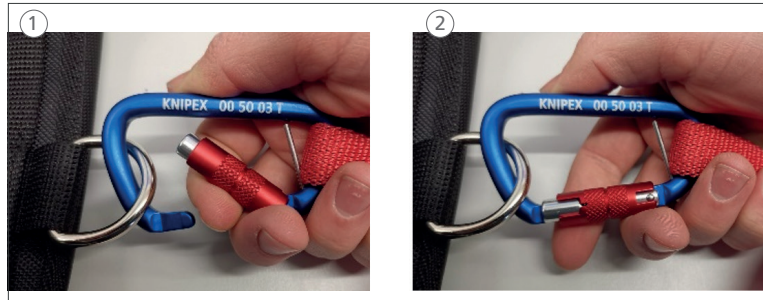

Figure 7: Connection via carabiner

1. Open the self-locking carabiner by rotating the red locking gate and pushing the latch inside and connect it to the D-ring.
2. Make sure there is clearance for the locking gate of the carabiner to close.

5.3.2 To use the loop end



Figure 8: Connection via loop

1. Pass the loop end through the D-ring on the tool bag.
2. Take the end of the Lanyard, which can be with or without a carabiner, and pass it through the loop.
3. Pull tightly to cinch and create a solid connection.
4. Push the cord stopper tightly to the cinch.

5.3.3 Connecting Adapter Straps

To connect a KNIPEX Adapter Strap:

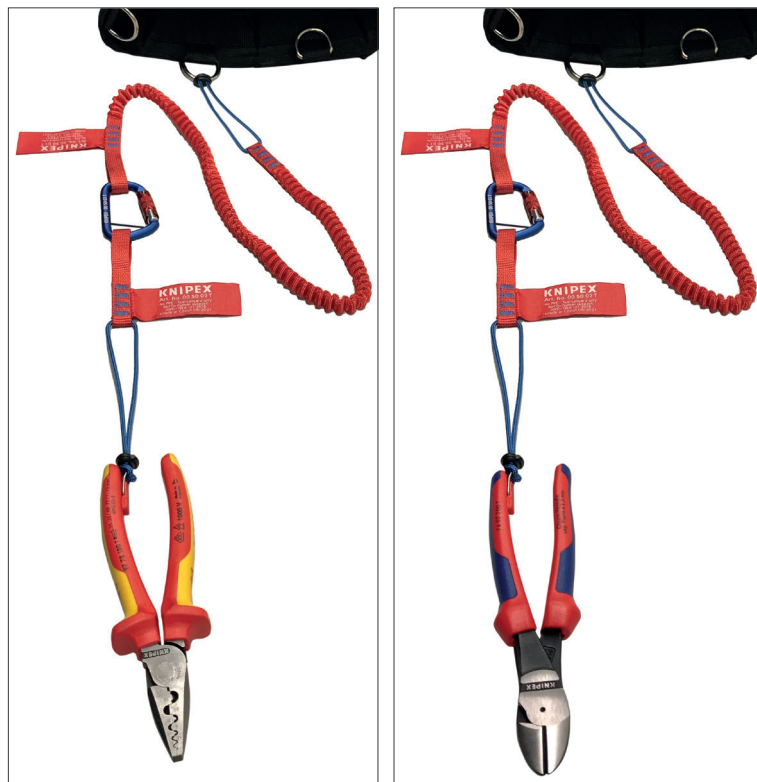

Figure 9: Connecting Adapter Straps

1. Connect the Adapter Strap to the tool via loop and connect this to a lanyard which is fastened to a D-ring as described in chapter 5.3.2.
2. Connect the Adapter Strap to the Lanyard or anchor point via carabiner as described in chapter 5.3.1.

HOW TO USE THE TOOL BAG

5.4 Opening the top cover

⚠ WARNING

Risk of injury from falling objects!

During transport and ascent or descent on a rope, on ladders, etc., the Tool Bag **must be closed** to prevent tools and materials from falling out, all of which must be attached to the bag by means of a Lanyard or Adapter Strap.

For easy and quick access to the tools while working, you can roll up the top cover and fix it with the two elastic loops on the back of the Tool Bag (see figure 10).



Figure 10: Roll up the top cover and fix it with two elastic loops

5.5 Use of tools



Figure 11: Use of tools (TOOLS NOT INCLUDED!)

HOW TO USE THE TOOL BAG / INSPECTION

- Always keep tools tethered while working at heights. When exchanging tools, use a 100% tie-off by ensuring the tool is tethered to a secondary anchor before disconnecting from the initial anchor point.
- When using KNIPEX Tool Lanyards and Adapter Straps, determine the fully stretched length of the Lanyard used, plus the length of the Adapter Strap if used, plus the tool itself. Add an additional safety factor to ensure an adequate clearance between where the Lanyard is anchored and the nearest person or object.

6 Inspection

KNIPEX Tethered Tools Tool Bags must be thoroughly inspected before each use. Any KNIPEX Tethered Tools Tool Bags components that has deformities, unusual wear or deterioration must be immediately removed from service and destroyed.

Inspect the entire surface of the component, carefully rotating it while visually inspecting for damage or wear that might affect its usability and dependability. Inspect material and stitching, hardware, D-Rings and connectors. In any doubt, please ask your supervisor for help. Inspect all seams of the D-rings for damage.

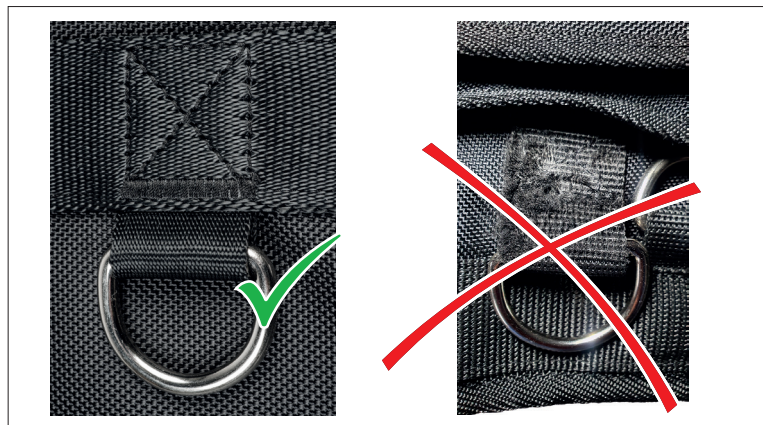

Figure 12: Inspect seams of the D-rings for damage

7 Storage and Care

- Store Tool Bag in a clean, dry location away from direct sunlight and heat.
- The ideal storage temperature is 18 - 22 °C (64 - 71.6 degree F).
- To clean, use mild soap and luke warm water. Hand wash only.
- Air dry only.

8 Disclaimer

KNIPEX-WERK C. Gustav Putsch KG ei missään olosuhteissa vastaa mistään suorista, epäsuorista, rankaisevaan vahingonkorvaukseen oikeuttavista, satunnaisista, erityisistä tai välillisistä vahingoista, jotka aiheutuvat KNIPEX Tethered Tools -työkalun virheellisestä käytöstä tai liittyvät siihen.



KNIPEX-Werk
C. Gustav Putsch KG

42337 Wuppertal

Tel.: +49 202 – 47 94-0
Fax: +49 202 – 47 74 94

info@knipex.com
www.knipex.com